



YuSnap+™ App

CONFIDENTIAL

DO NOT COPY OR RE-DISTRIBUTE WITHOUT PRIOR
WRITTEN CONSENT FROM GERBER TECHNOLOGY LLC

YuniquePLM © 2021 Gerber Technology LLC All Rights Reserved.

YuniquePLM® and YuSnap+™ are registered trademarks of Gerber Technology LLC.

iOS® and App Store® are registered trademarks of Apple, Inc.

Android™, Google Play and the Google Play logo are registered trademarks of Google LLC.

The information in this document is copyright protected. No part of this manual may be copied or reproduced in any form without prior written consent from Gerber Technology LLC.

GERBER TECHNOLOGY LLC SHALL NOT BE LIABLE FOR OPERATIONAL, TECHNICAL OR EDITORIAL ERRORS/OMISSIONS MADE IN THIS MANUAL.

The information in this document may be subject to change without prior notice. YuniquePLM is a registered trademark of Gerber Technology LLC.



24 Industrial Park Road West

Tolland, CT USA

USA, 1-212-868-7795 or 1.800.321.2448

International 1.860.871.8082

CONFIDENTIAL

DO NOT COPY OR RE-DISTRIBUTE WITHOUT PRIOR WRITTEN CONSENT FROM GERBER TECHNOLOGY LLC.

Contents

Overview	1
Features	1
Installing YuSnap+	3
Apple's App Store.....	3
Google Play Store.....	4
Configuring YuSnap+.....	5
Using YuSnap+.....	6
Home - Images	7
Catalog	8
Take Photo - Camera.....	10
Upload.....	11
QR Code Scan	13

Overview

Inspiration can strike at anytime. With YuSnap+, for YuniquePLM, your design, development, merchandising and sales teams can easily capture and share digital photos while they're on the go. This intuitive app, available on the Apple App store and Google Play store, accelerates product development and promotes communication and collaboration.

Features

- Capture and upload photos directly from your mobile device and import them directly into your companies YuniquePLM application.
- View and update existing images within the app
- Capture sample fitting images and update via QR Code
- Build and manage Story Boards
- Collaborate with your team in the app
- Upload multiple images at once.
- YuSnap+ is compatible with YuniquePLM v8.1 and later.
- YuSnap+ for Android launched with v8.8
- YuSnap+ is available on [iOS](#) and [Android™](#) devices via their Apple App Store and Google Play Store.

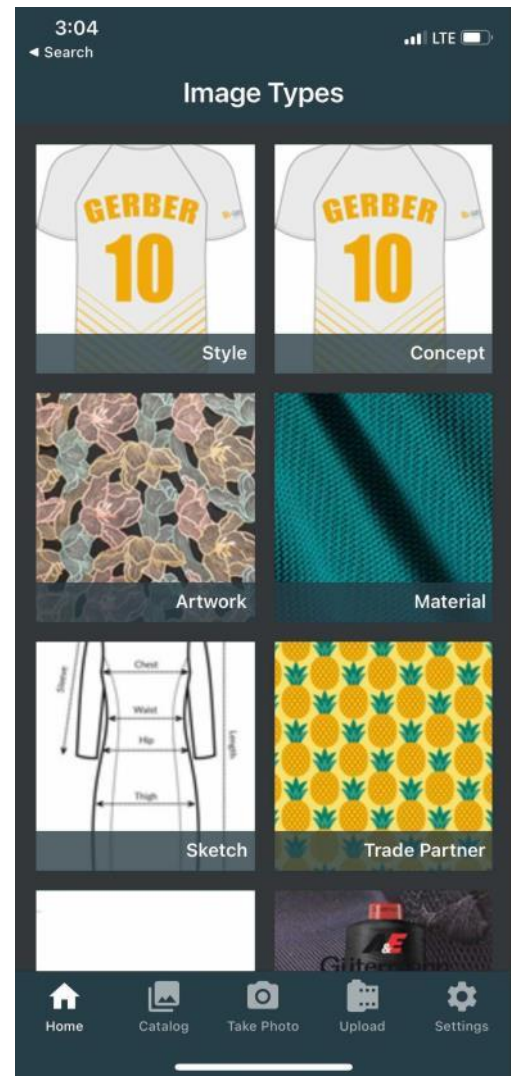

YuniquePLM Requirements

To use YuSnap+, each user must have *permission to work remotely* and obtain the *server setup configuration* details. Please note only users with YuniquePLM Admin access can enable this step.

1. Login to **YuniquePLM** and select **Admin**.
2. Locate and select a **User**. The default page opens to the User Options tab.
3. Make sure the **External Access** box is selected.
4. Press **Save** then **Close**.

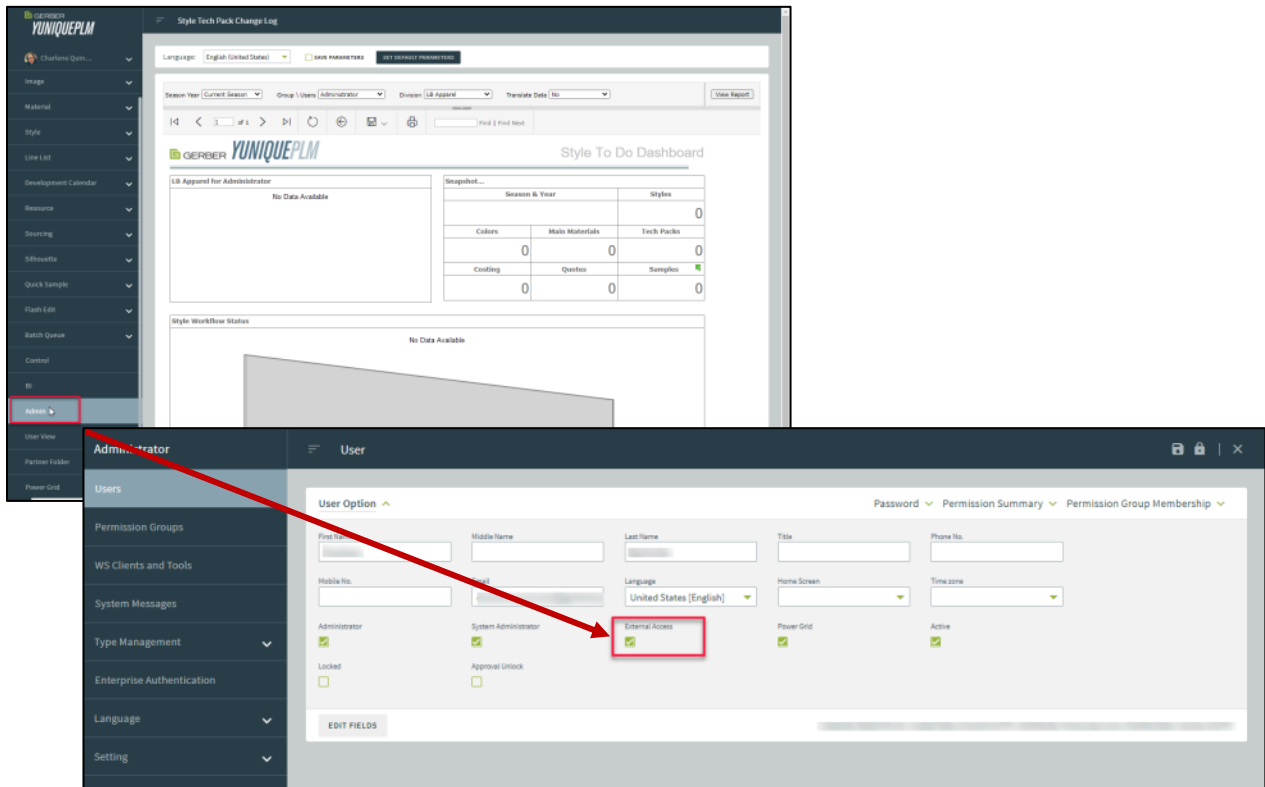

5. Select **WS Clients and Tools** within the left navigation bar,
6. The YuSnap server details are listed and are needed for the app. Users have the option to manually enter the details below OR quickly by scanning a QR code. Leave this window open to refer to the server details within the [Configuring the YuSnap+ app](#) section.

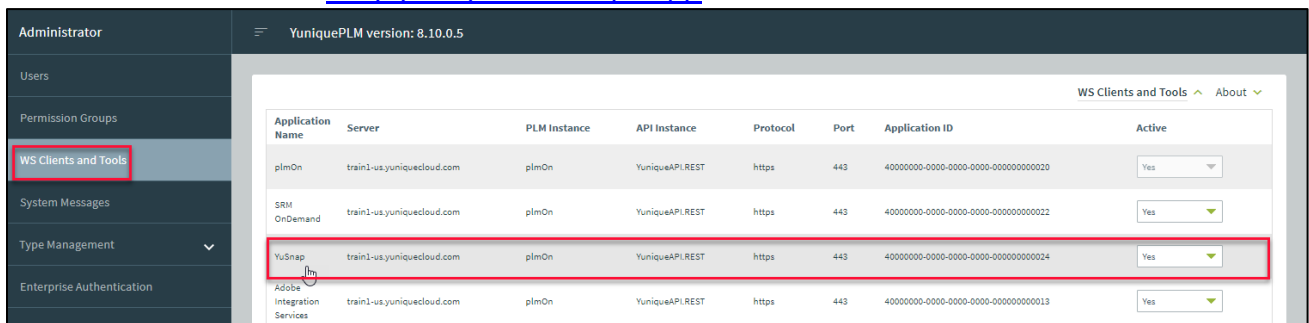

Installing YuSnap+

The YuSnap+ app is available on Apple's App Store for iOS devices and the Google Play Store for Android devices.

Apple's App Store

1. Tap the **App Store** icon; then press **Search** to enter and locate the **YuSnap+** app.

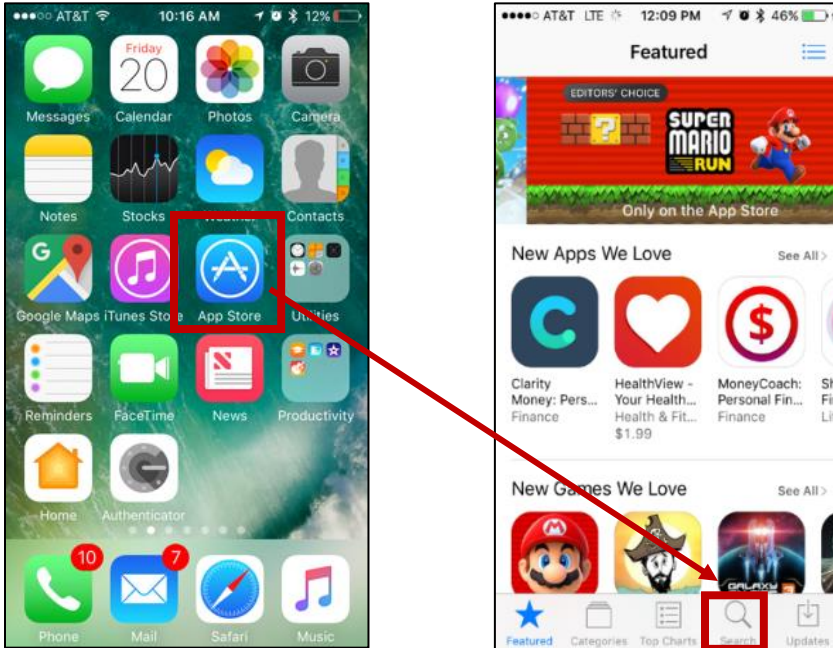

2. Press **Get** to begin the download process. You may also be required to login with your Apple ID to authorize the free purchase. **Open** the YuSnap+ app.

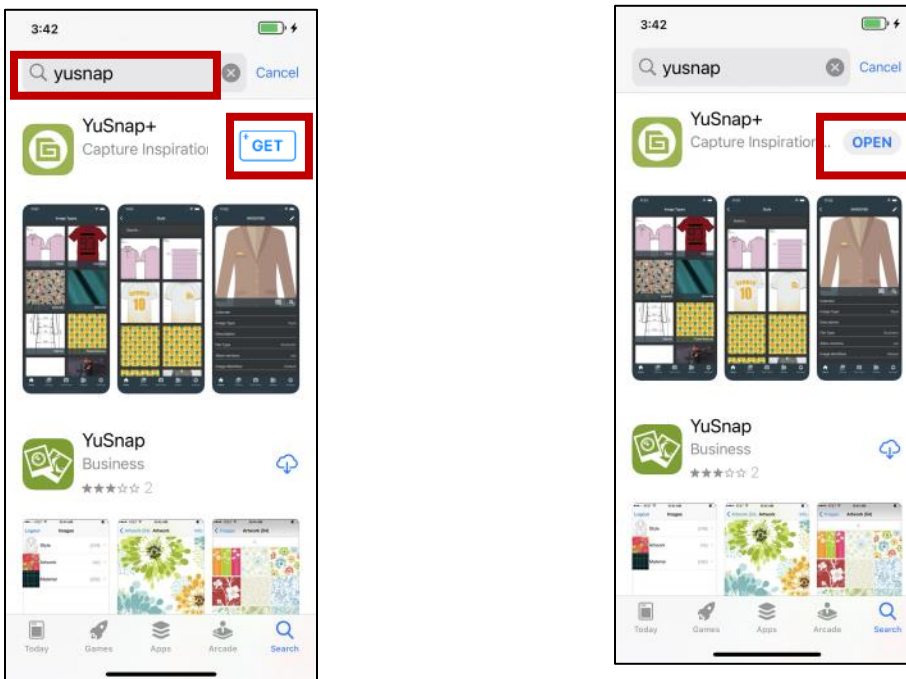

Yusnap + User Guide

Google Play Store

1. Navigate to the **Google Play** store on an Android device and search for YuSnap+.

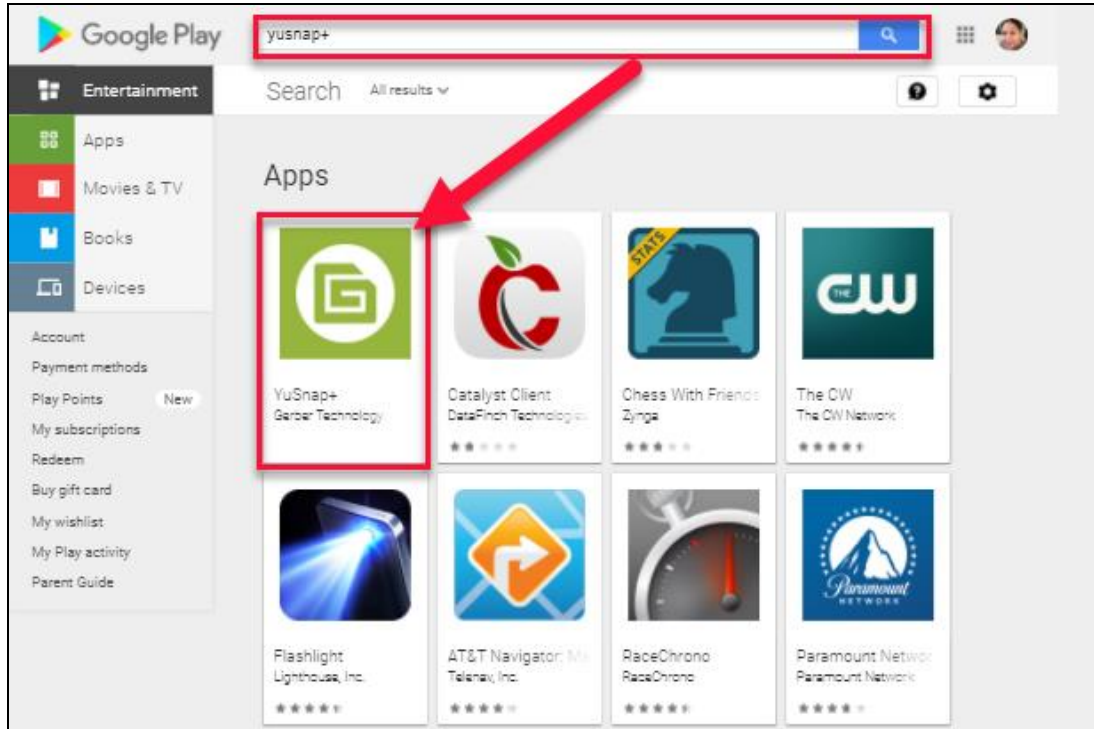

2. Press **Install** to download and install the app.

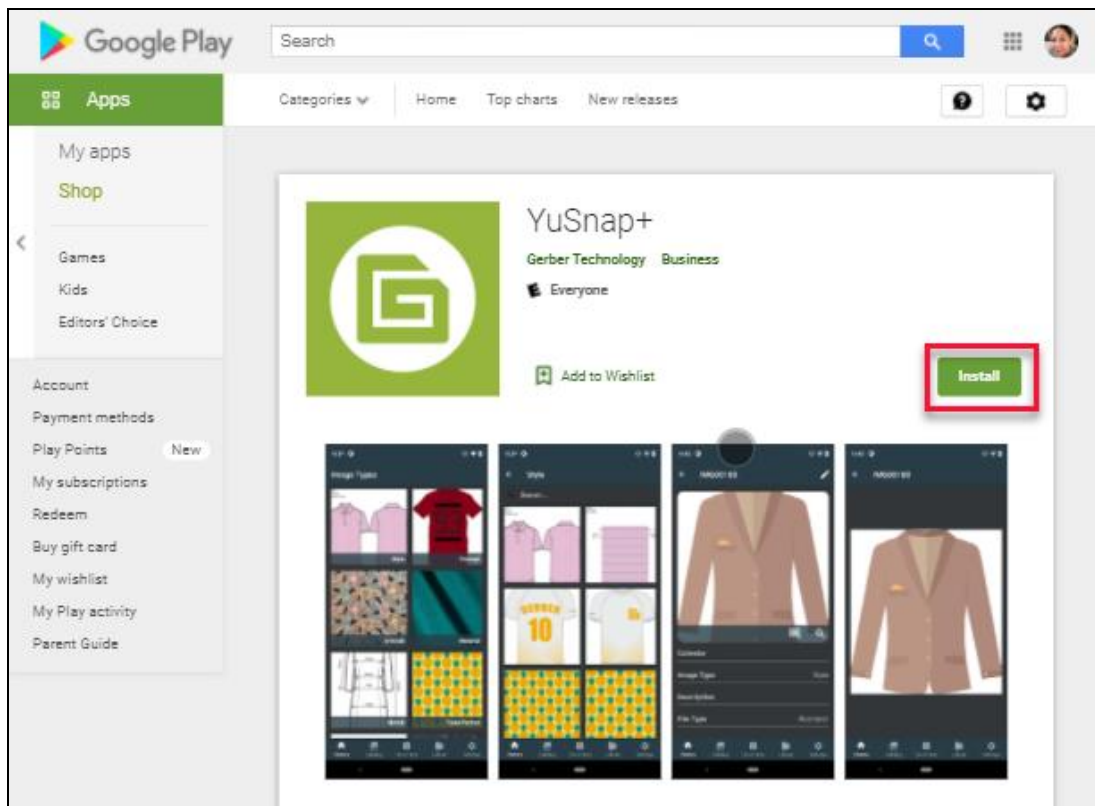

Configuring YuSnap+

1. Open the user's **Profile** page within YuniquePLM.

Note: The QR code adjacent to the profile pic will be scanned in a later step.

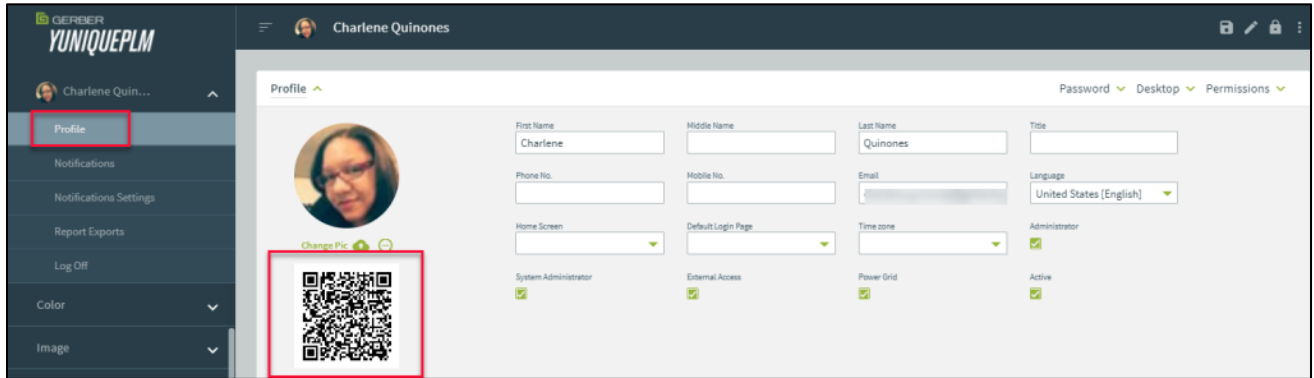

2. The **Settings** page is shown after opening the *YuSnap+* app.
3. Press the **QR code icon** and the mobile camera will open.
4. Using your mobile device, **scan the QR code** on the *User Profile* page, as shown above. The QR Code icon allows the user to quickly enter the necessary configuration details by capturing the QR Code from their User Profile page using the mobile device's camera
5. The YuniquePLM server details automatically populate:
 - **Server**
 - **API Instance**
 - **Protocol**
 - **Port**
6. Enter your **username** and **password**.
7. Press the **save** icon on the upper right-hand corner.
8. The YuSnap+ app automatically updates and opens to the **Home-Image Types** area.

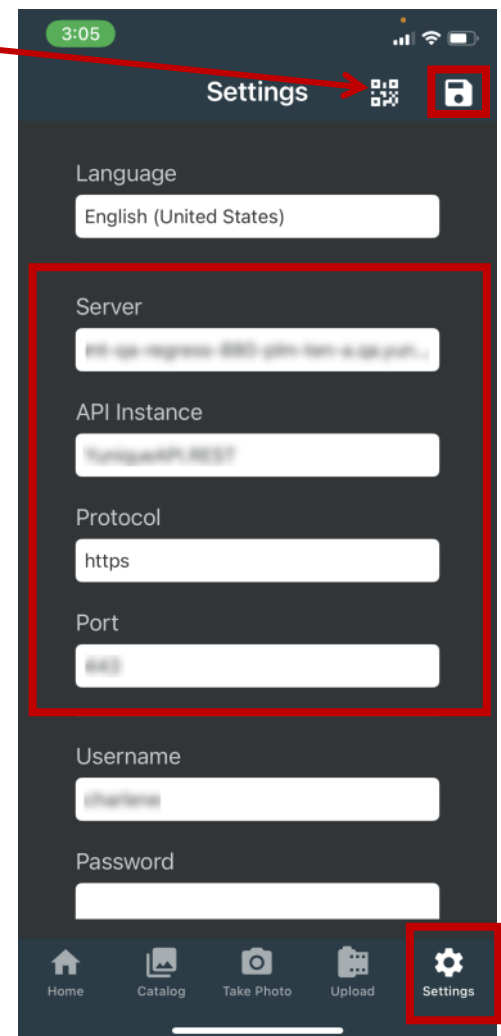

Using YuSnap+

YuSnap+'s Home page opens and displays Image Types available in YuniquePLM. Select from one of the four icons to use different features.

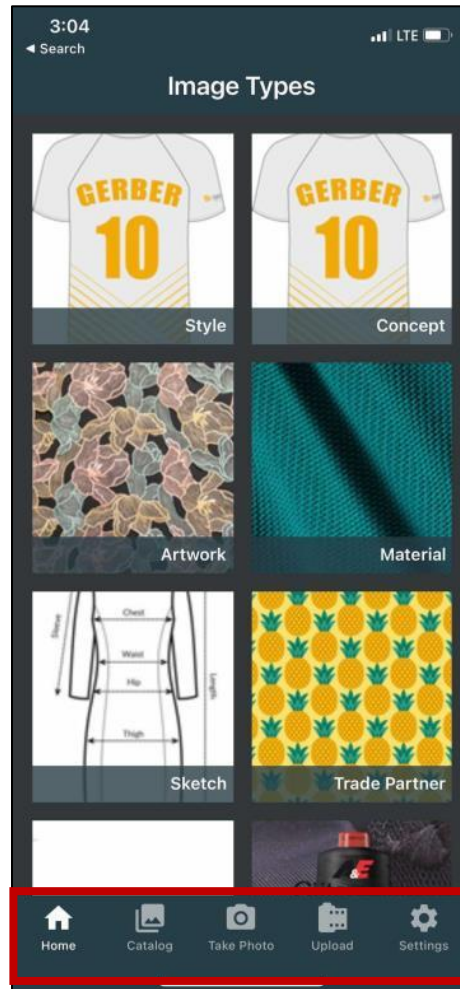

- **Home:** View images listed by category, description and associated comments.
- **Catalog:** Access the Image Catalog to view images organized into specific groups.
- **Take Photo:** Quickly snap photos into YuniquePLM via the *camera* option by providing YuSnap+ access to your iOS device's camera.
- **Upload:** Add one or more images from your iOS device's photo library to the YuniquePLM Image library.
- **Settings:** Displays the language, server details and login credentials.

Home - Images

1. Tap on an **image category** to view and **select an image** from the available list.

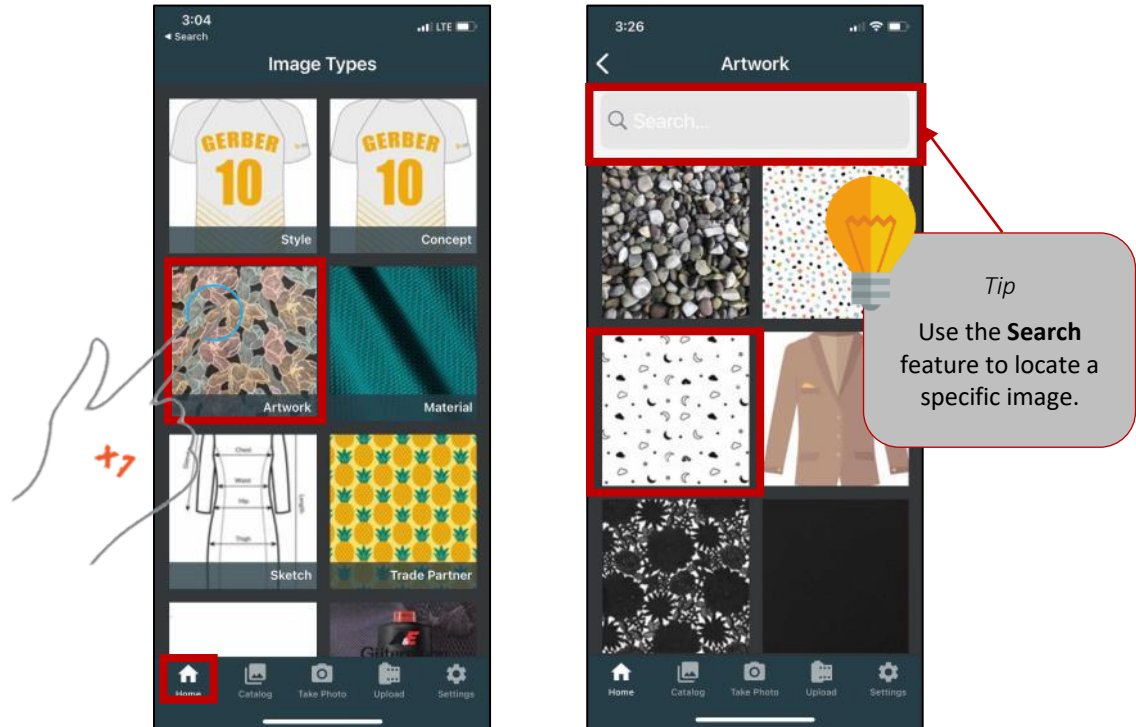

2. Each image contains its image attributes while also providing the ability to edit attributes, add a comment and view an enlarged image.
 - Select **Edit** to view and update assigned *Image attributes*, then click **Save** to keep any changes.
 - Select the **Comment** icon to view or add comments, then click **Save** to keep any changes.
 - Selecting the **magnifier** displays an enlarged image.

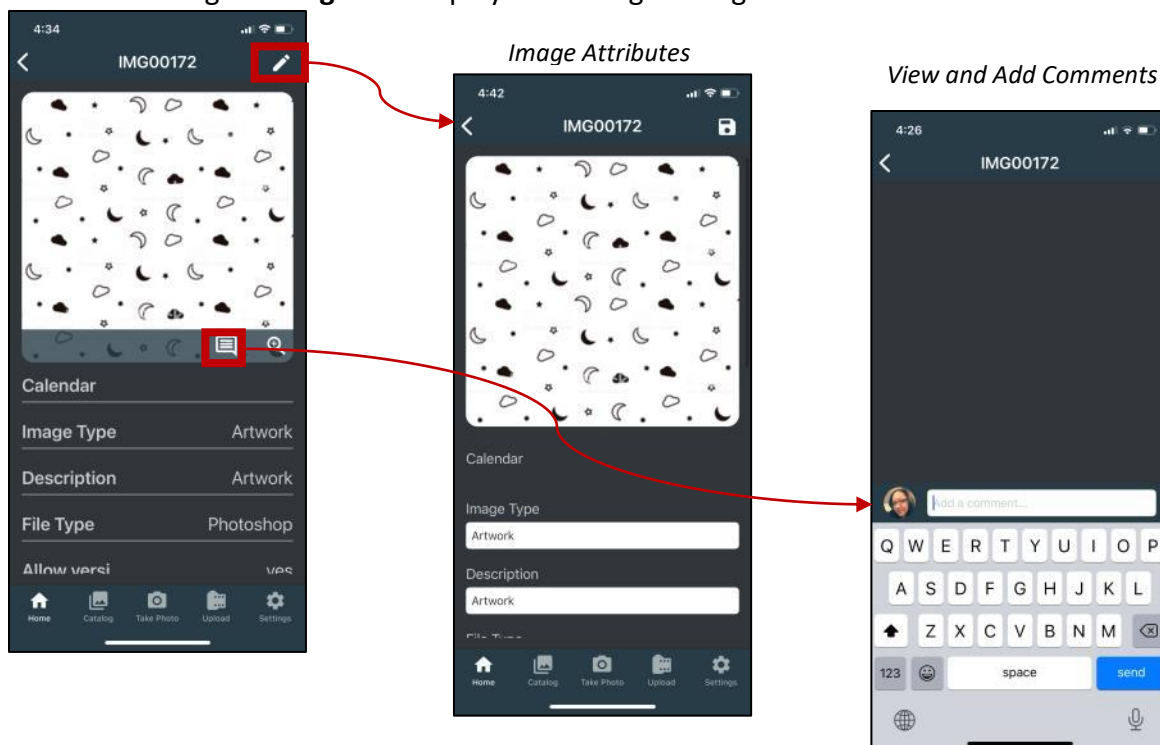

Catalog

1. Press **Catalog** on the bottom of the home page.
2. The *Image Catalog* opens allowing the user to *tap, scroll, or create* a desired catalog. Tap a catalog to view the included images.

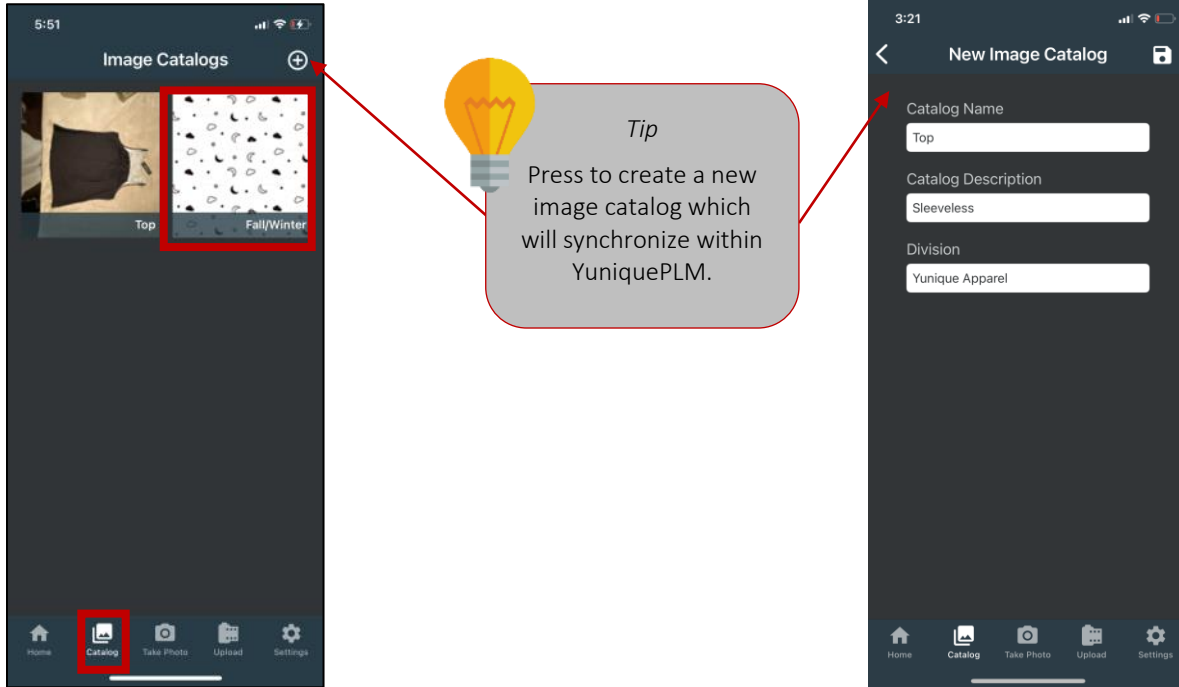

3. *Tap* an image to view its larger version along with its attributes. Select the **pencil** icon to edit the images attributes, press the **delete** icon to remove an image from the catalog, select the **comment** icon to add one and finally select the **magnifier** to view a larger image.

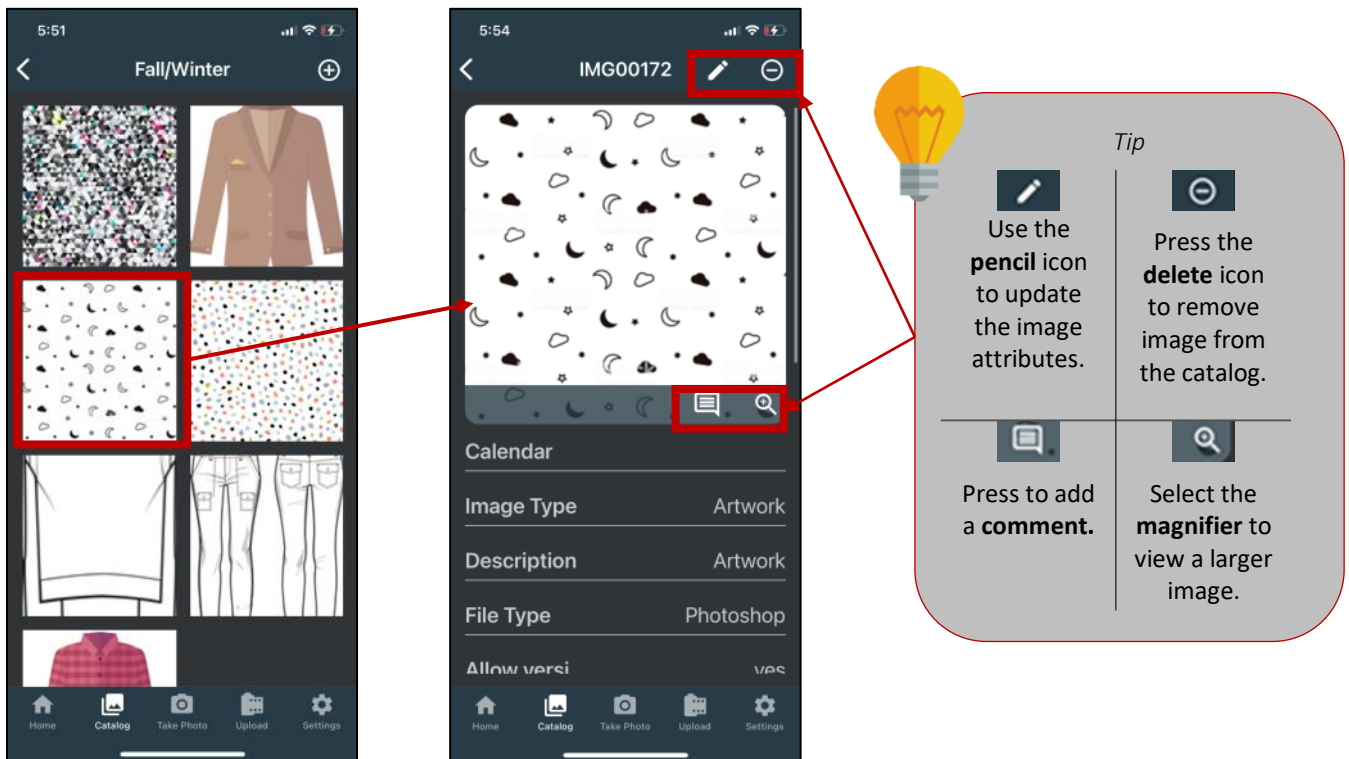

Yusnap + User Guide

- Users can also add a new image to the selected catalog by pressing the **plus sign** and following the prompts to select an image from the *YuniquePLM Images* folder then follow the remaining screens to add the image.

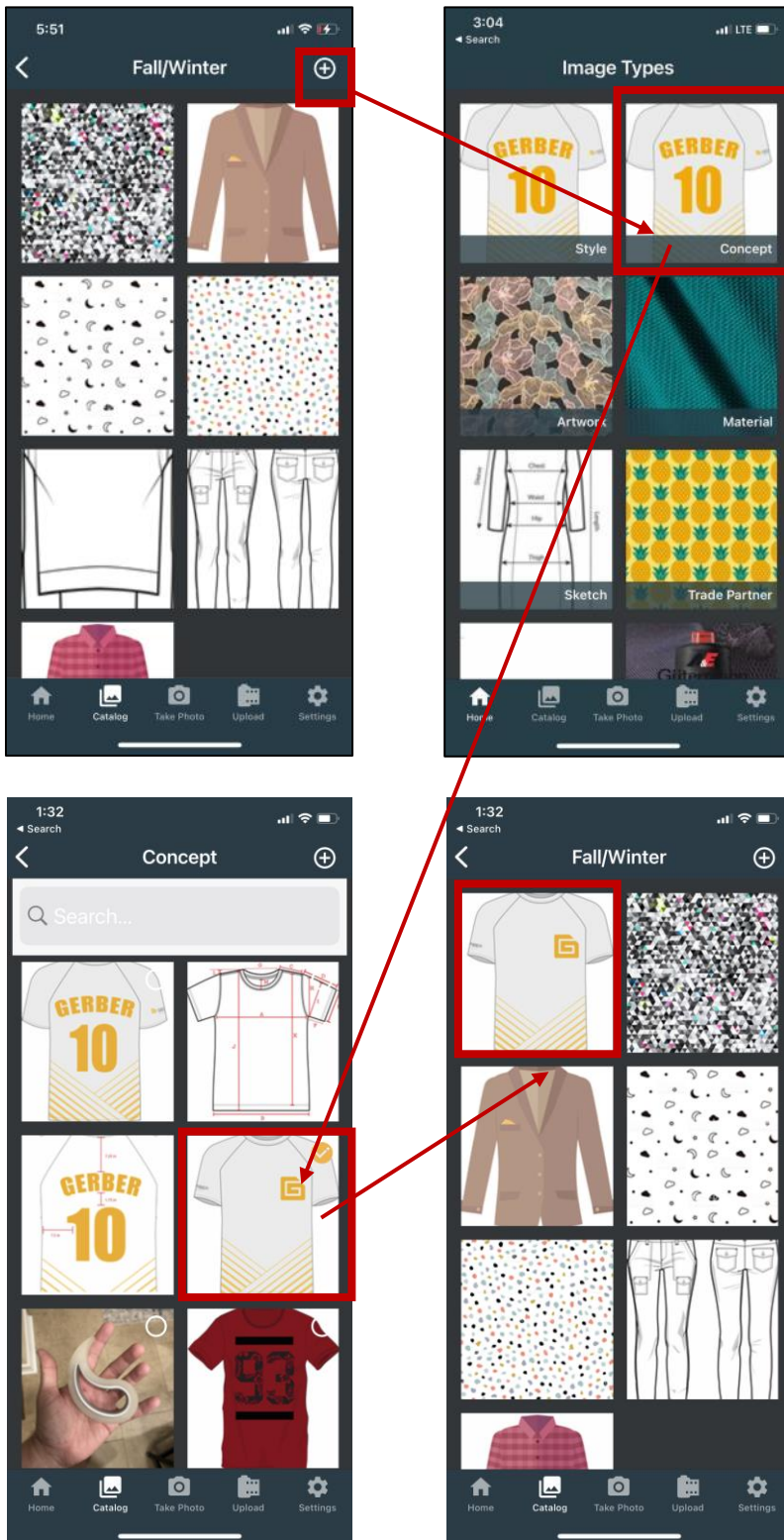

Take Photo - Camera

1. Select the **camera** icon to take a snapshot of the desired image.

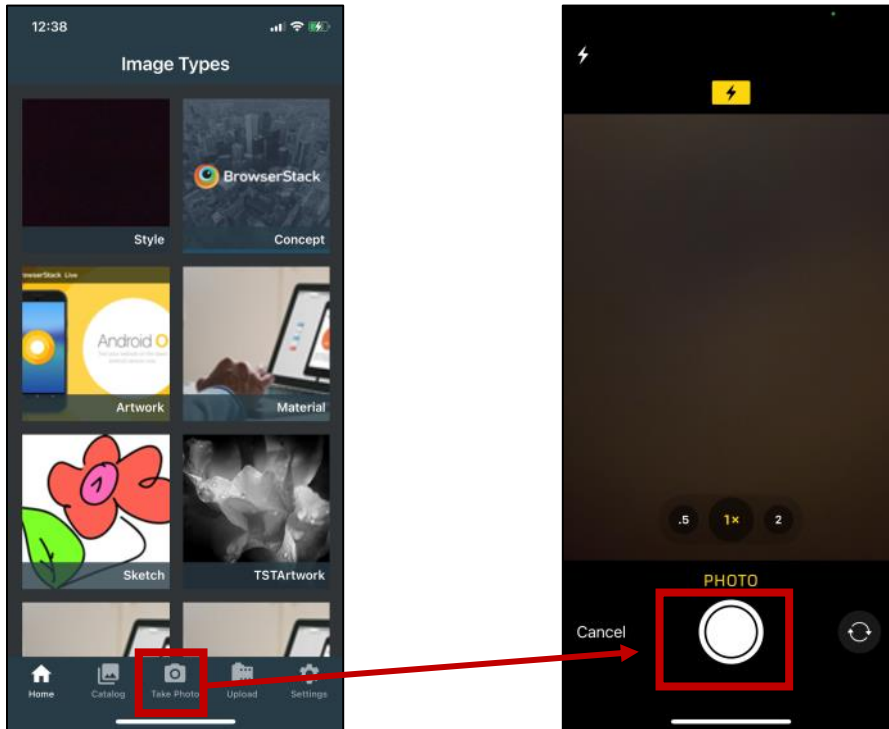

2. A **New Image** window opens. Select **attributes** within each drop-down. Make sure to select an **Image Type** and **Image Workflow** then proceed with filling in the rest of the attribute fields as required.

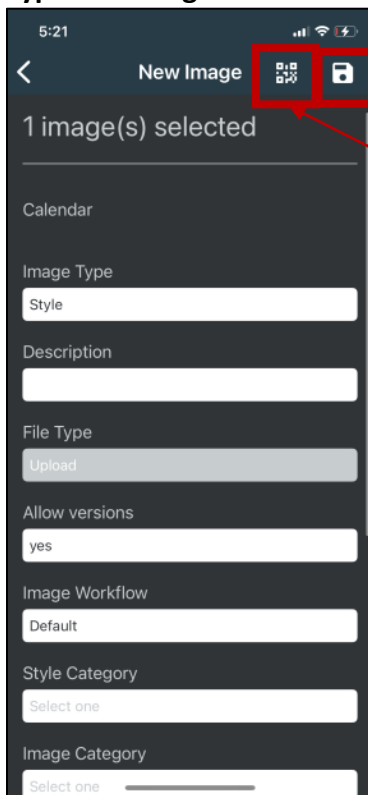

Tip

Save the image directly into a Style's Sample Request Submit page as shown in the [QR Code Scan](#) section.

3. Press the **Save** icon and the new image is included in the YuniquePLM Image Library.
4. The new image is now available within YuniquePLM's Image Library.

Upload

1. Press **Upload** then **locate your desired image**.

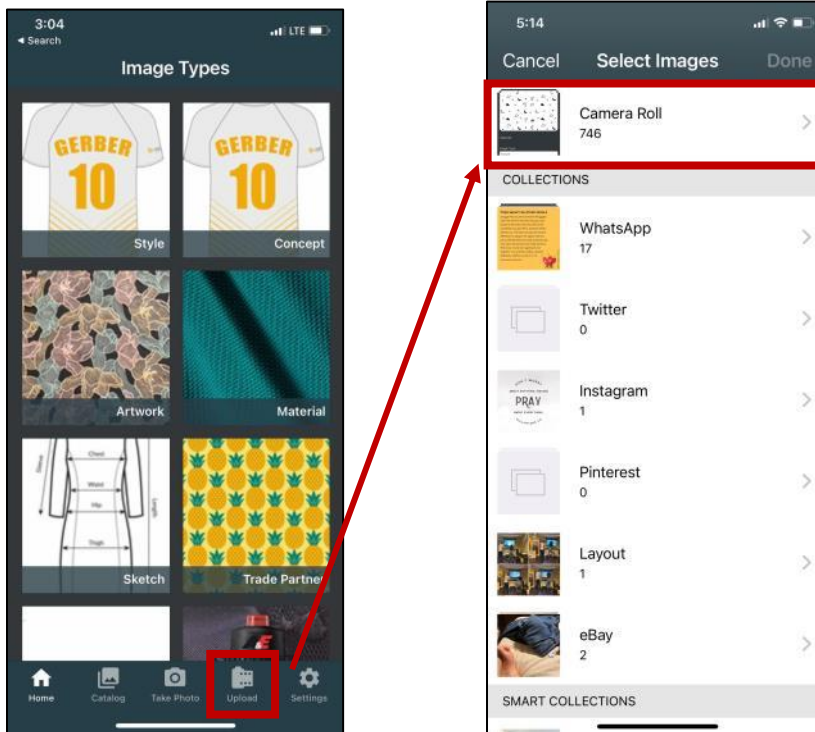

2. Select one or more images and tap **Done**.

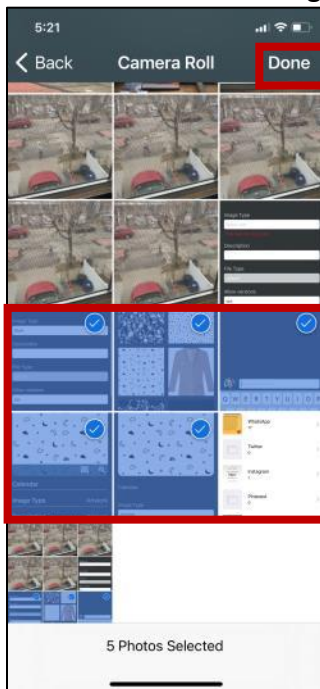

3. A *New Image* window opens. Select **attributes** within each drop-down. Make sure to select an **Image Type** and proceed with filling in the rest of the attribute fields as required.
4. Users can save the image by pressing the **save** icon to include it in the image library. Once saved, the app refreshes and returns to the Home tab.

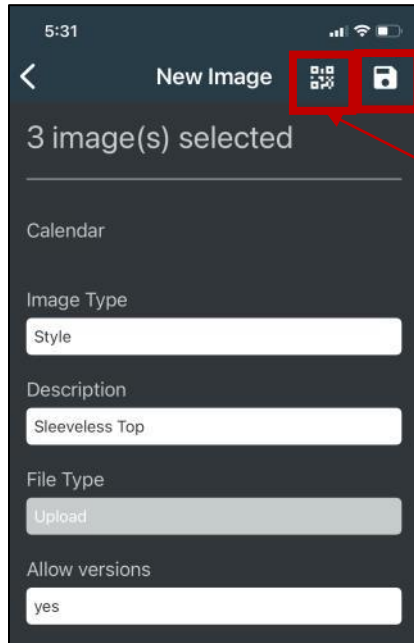

Tip

Save the image directly into a Style's Sample Request Submit page as shown in the **QR Code Scan** section.

Yusnap + User Guide

QR Code Scan

Alternatively, users can quickly add a new image to a *Style Folder's Sample Request-Submit Status* by using the **QR code** and cutting out extra steps.

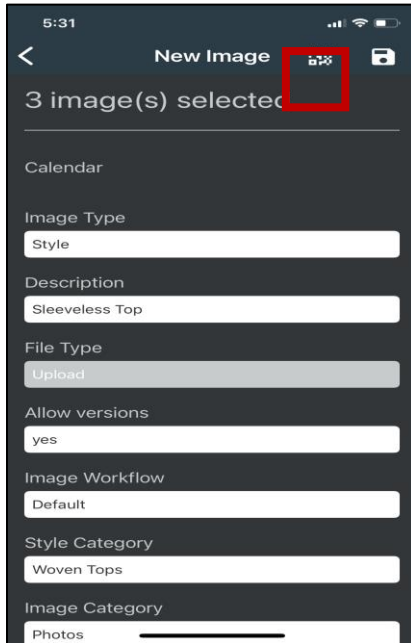

1. In **YuniquePLM**: First ensure the QR Sample setting is enabled. Navigate to **Admin>Setting>Application>Style>General**, then make sure *EnableQRSampleIntegration* is set to TRUE.
2. Open a desired *Sample Request Submit Status* and click the **QR code**. A Fit Session window opens with a QR code.

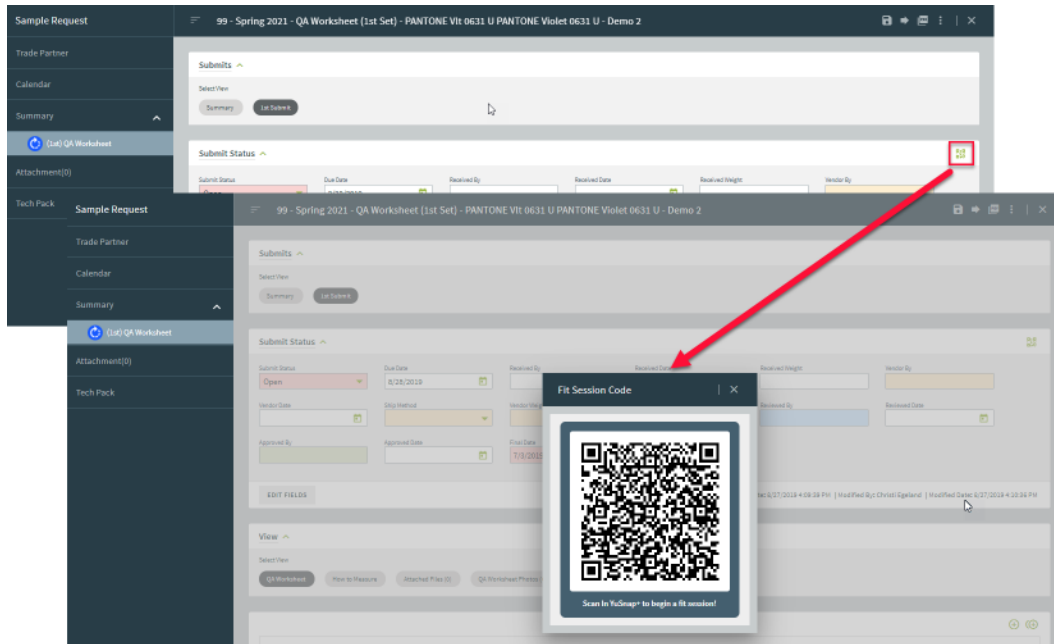

3. **In the Mobile App:** Click the **QR code** to open the mobile camera. Take a picture of the Sample Request's QR code. The app refreshes and return's to the Home page.

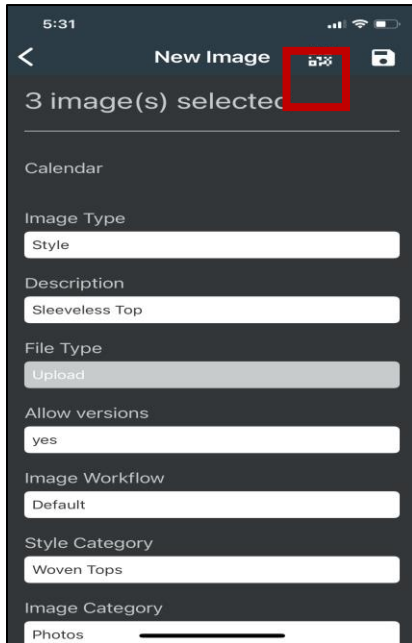

4. **In YuniquePLM:** Close the **Fit Session** window and refresh the *Sample Request* page, then click on the Sample Submit Status, ex. *QA Worksheet Photos*.

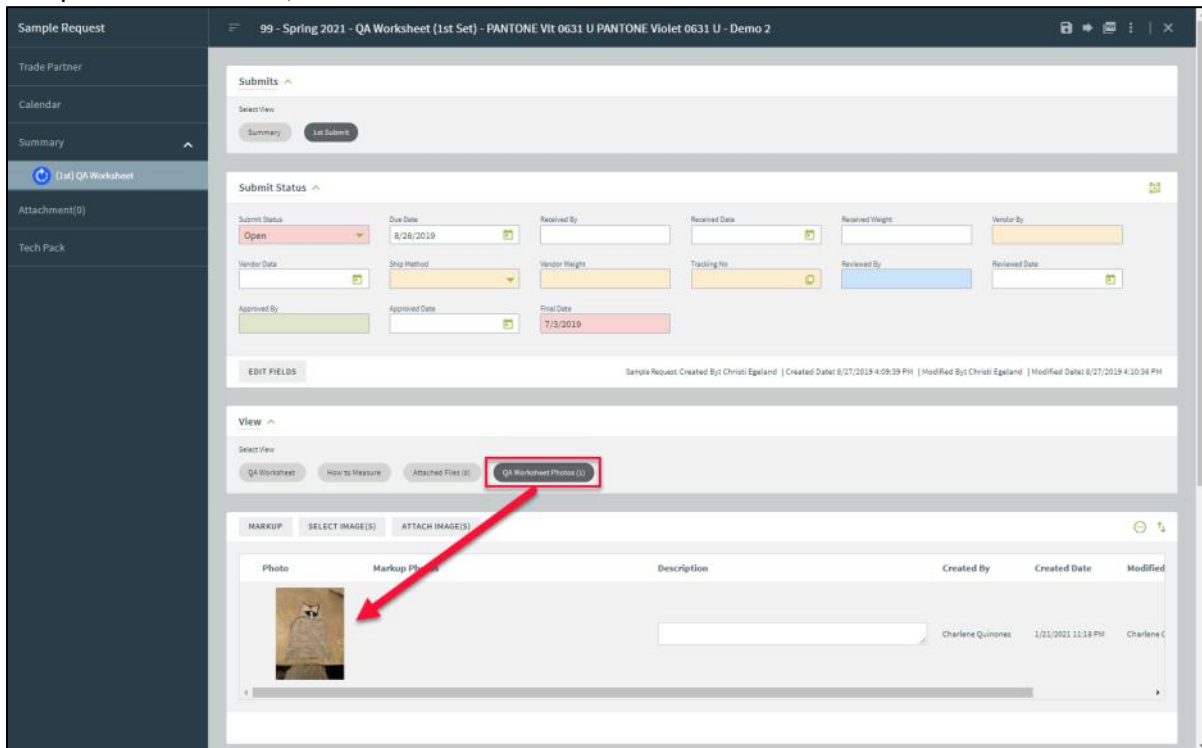

5. The image is now available within the Sample Request –Submits Photo tab.



24 Industrial Park Road West

Tolland, CT USA

USA, 1-212-868-7795 or 1.800.321.2448

International 1.860.871.8082